

## FSCDRDM/FSCDRDS Core Drill Round Spigot

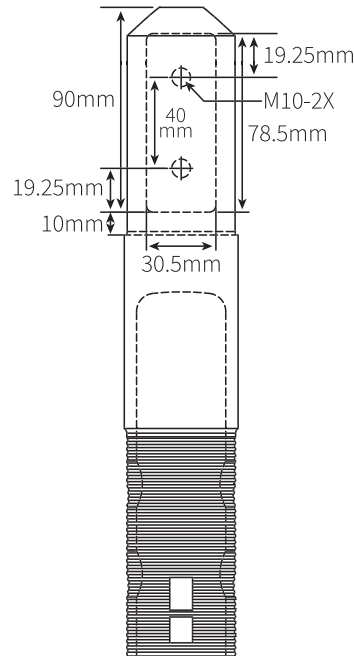

### AVAILABLE FINISHES

- Mirror
- Satin

### TECHNICAL DETAILS

- Duplex 2205 Stainless Steel
- Friction fit
- Diameter 50 x 280mm
- Available in round with hole in glass

## Spigot Round Cover

Diameter 100mm

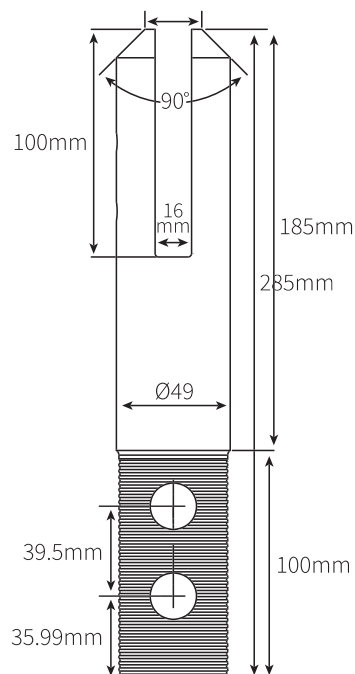
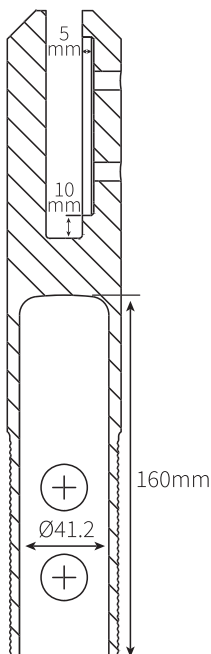

## FSSQCDM/FSSQCDS Core Drill Square Spigot

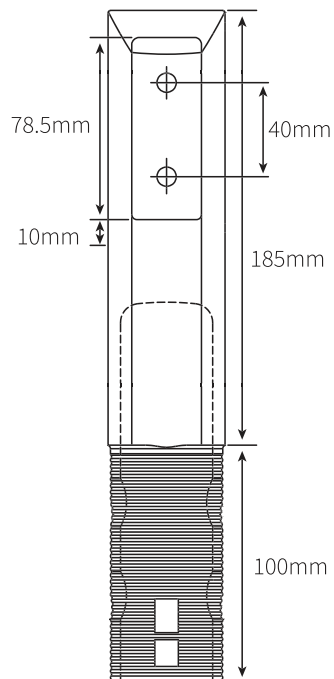

### AVAILABLE FINISHES

- Mirror
- Satin
- Black

### TECHNICAL DETAILS

- Duplex 2205 Stainless Steel
- Friction fit
- 50 x 48 x 280mm
- Available in round with hole in glass

### Spigot Square Cover

Diameter 100mm

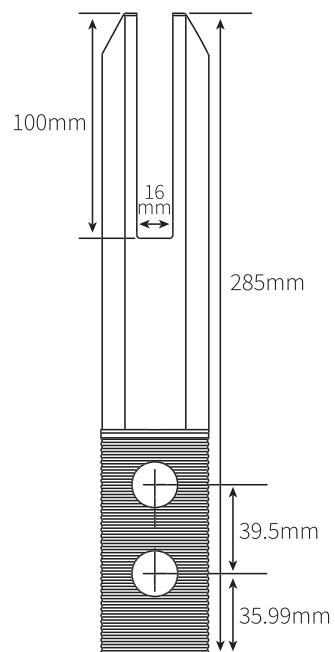
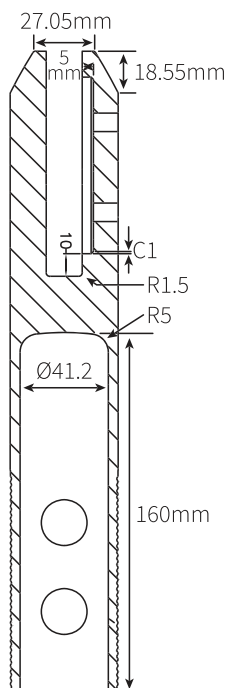

## FSBMRDM/FSBMRDS Base Mount Round Spigot

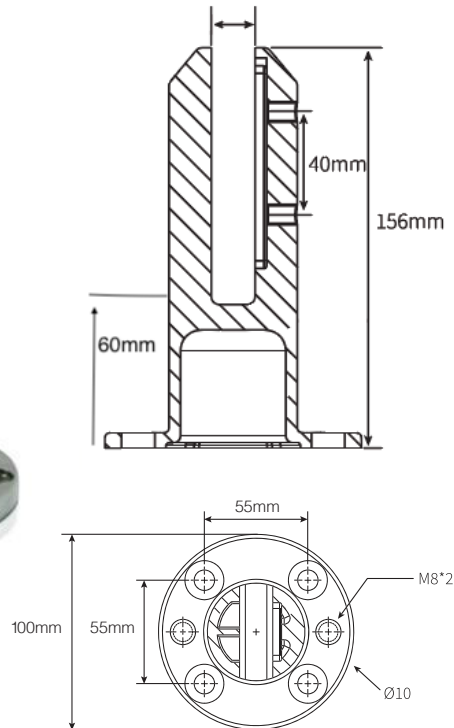

### AVAILABLE FINISHES

- Mirror
- Satin

### TECHNICAL DETAILS

- Duplex 2205 Stainless Steel
- Friction fit
- Diameter 50 x 180mm
- Available in round with hole in glass

### Spigot Round Cover

Diameter 105mm



## FSBMSQM/FSBMSQS Base Mount Square Spigot

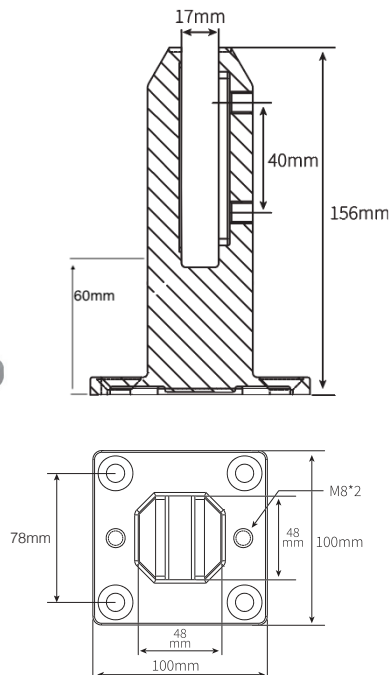

### AVAILABLE FINISHES

- Mirror
- Satin
- Black

### TECHNICAL DETAILS

- Duplex 2205 Stainless Steel
- Friction fit
- 50 x 48 x 180mm
- Available in round with hole in glass

### Spigot Square Cover

105 x 105mm



## SMHGSM/SMHGSS Side Mount Spigot



### AVAILABLE FINISHES

- Mirror
- Satin

### TECHNICAL DETAILS

- Duplex 2205 Stainless Steel
- Friction fit
- Holes required in glass

## Madrid Side Mount – Friction Fit

### CONCRETE FIX

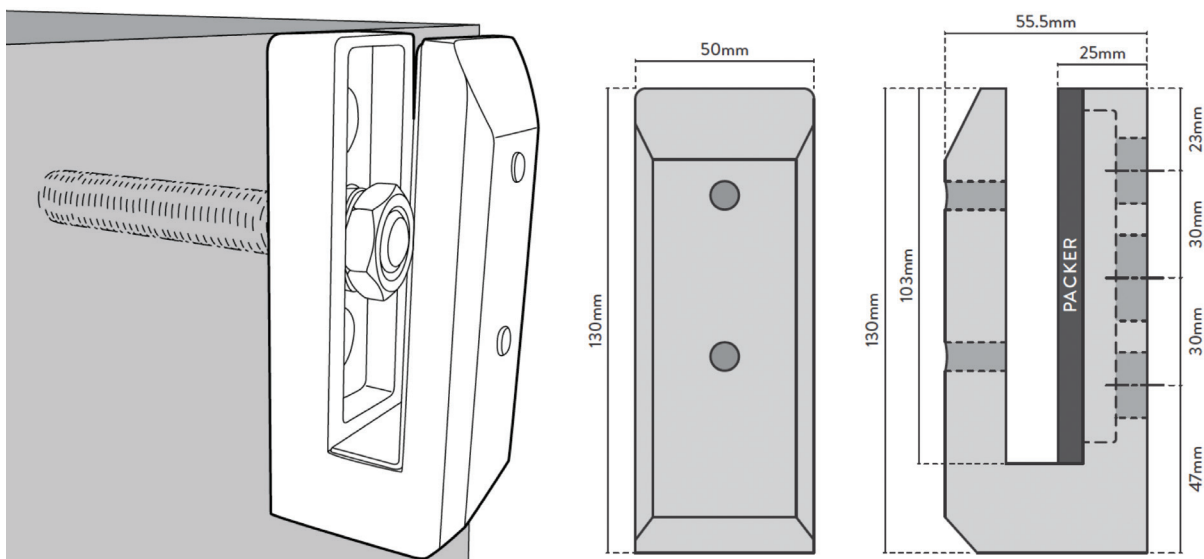

### AVAILABLE FINISHES

- Polished Stainless Steel
- Satin Stainless Steel

### TECHNICAL DETAILS

- Friction fit
- Side Mount

## GHA Side Mount – Adjustable

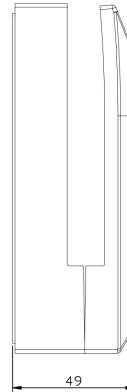
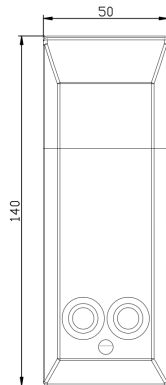

### AVAILABLE FINISHES

- Mirror
- Satin

### TECHNICAL DETAILS

- Adjustable body
- Friction fit
- NO holes needed in glass

- 1 Wall bracket
- 2 Adjustable body
- 3 Surface cover
- 4 Adjustment grub screw
- 5 Spacers
- 6 Threaded bolts
- 7 Countersunk screws

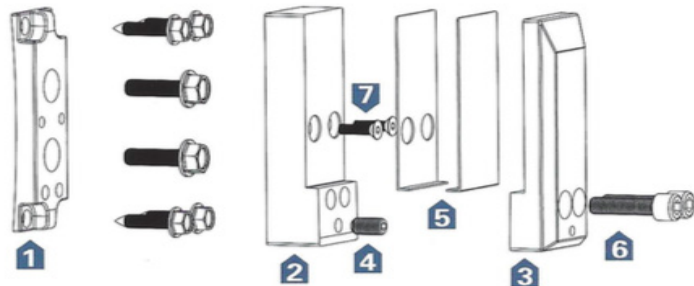

### INSTALLATION INSTRUCTIONS

#### Step 1. Drill and fix the wall bracket

Using the wall bracket to mark out the hole positions, and drill holes accordingly. Then fix the Wall Bracket on the wall and tighten firmly.

#### Step 2. Fix the adjustable body

Using countersunk screws to fix the adjustable body to wall bracket, and tighten with Allen Key.

#### Step 3. Fix the surface cover on wall bracket.

Put surface cover on wall bracket. Don't tighten too firmly as glass needs room to be inserted.

#### Step 4. Install the glass panel

Insert glass panel inside GHA Side Mount Spigot, and adjust the glass panel to make it plumb.

**A.** To deflect inward, turn clockwise the adjustment grub screw to secure glass panel in place then tighten firmly the threaded bolts.

**B.** To deflect outward, turn anti-clockwise the adjustment grub screw to secure glass panel in place then tighten firmly the threaded bolts.

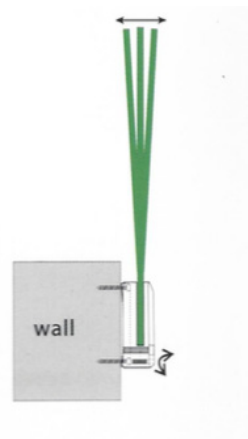
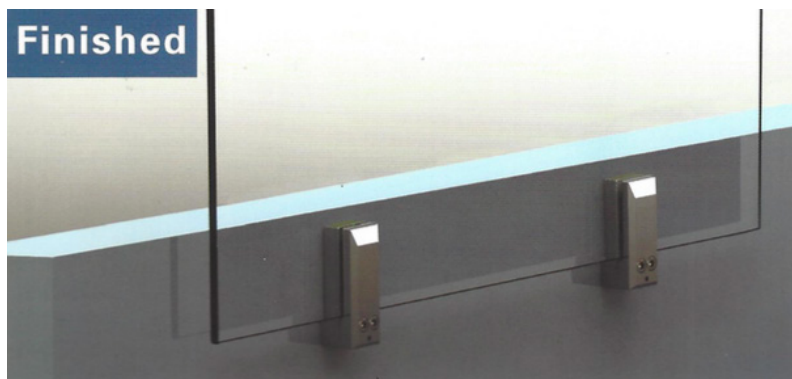

## NBF168 Nautech Strut Post Base Fix

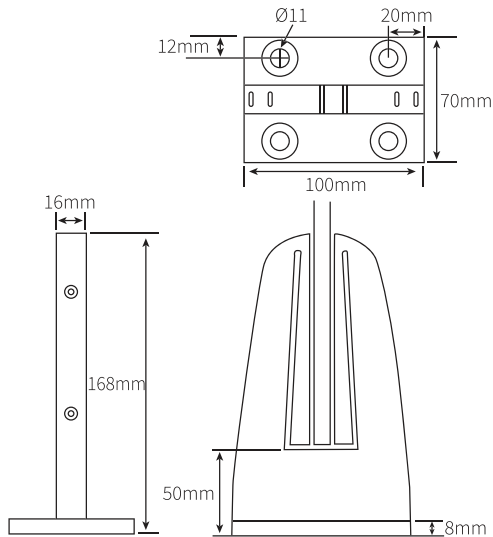

FIXING DETAIL –  
DOMESTIC WOOD  
FIX (CSW100)

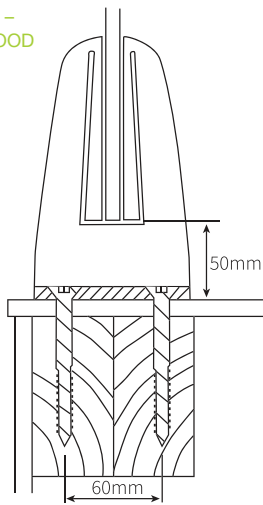

FIXING DETAIL –  
DOMESTIC  
CONCRETE  
FIX (MF43)

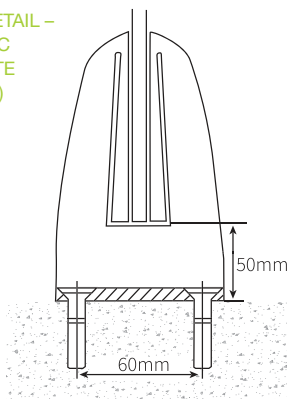

### AVAILABLE FINISHES

- Polished Stainless
- Satin Stainless

### TECHNICAL DETAILS

- The system is a unique strut post design which is unobtrusive, strong and durable
- The system features horizontal and vertical adjustment for the glass
- The vertical adjustment is attained by the use of a patented clamping and adjustment technique which is the heart of the fitting, it clamps the glass without the need for holes and this saves on glass processing costs and installation time
- The strut post is 168mm high and provides a 50mm clearance between the top of the deck and underside of the glass pane
- The NauTech system has been tested in NZ to AS/NZS 1170 barrier loadings in accordance with B1/VM1 Amendment
- Suits 12mm glass thickness (no holes or cutouts required)
- Domestic and commercial balustrades and pool fences
- Base fixing to masonry, timber and steel structures
- 16mm thick 316 grade stainless steel



## NSF315 Nautech Strut Post Face Fix

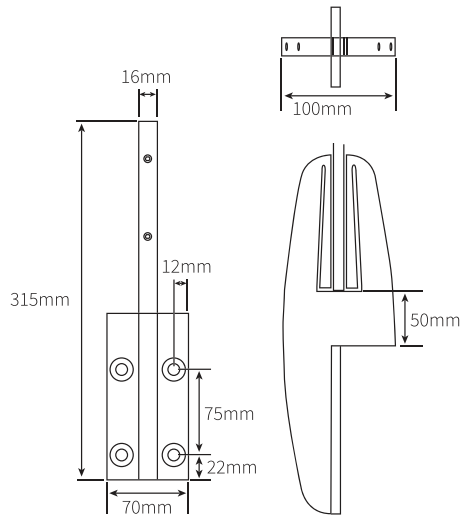

FIXING DETAIL –  
DOMESTIC WOOD FIX  
(CSW100)

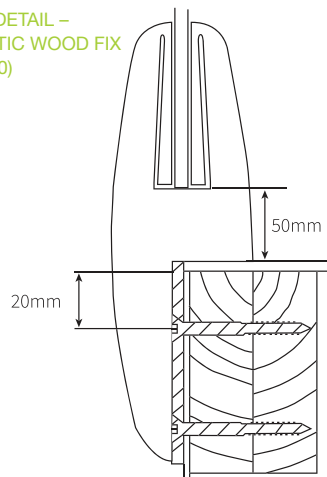

FIXING DETAIL –  
DOMESTIC  
CONCRETE  
FIX (MF43)

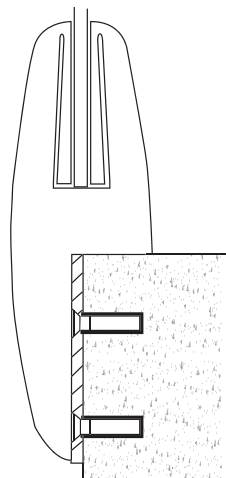

### AVAILABLE FINISHES

- Polished Stainless
- Satin Stainless

### TECHNICAL DETAILS

- The system is a unique strut post design which is unobtrusive, strong and durable
- The system features horizontal and vertical adjustment for the glass
- The vertical adjustment is attained by the use of a patented clamping and adjustment technique which is the heart of the fitting, it clamps the glass without the need for holes and this saves on glass processing costs and installation time
- The strut post is 168mm high and provides a 50mm clearance between the top of the deck and underside of the glass panel
- The NauTech system has been tested in NZ to AS/NZS 1170 barrier loadings in accordance with B1/VM1 Amendment
- Suits 12mm glass thickness (no holes or cutouts required)
- Domestic and commercial balustrades and pool fences
- Base fixing to masonry, timber and steel structures
- 16mm thick 316 grade stainless steel

**FS-15RC Heavy Duty Round Core Drill Spigot****AVAILABLE FINISHES**

- Mirror
- Satin

**TECHNICAL DETAILS**

- Suits 15mm glass

**FS-15SC Heavy Duty Square Core Drill Spigot****AVAILABLE FINISHES**

- Mirror
- Satin

**TECHNICAL DETAILS**

- Suits 15mm glass

**FS-15RD Heavy Duty Round Deck Mount Spigot****AVAILABLE FINISHES**

- Mirror
- Satin

**TECHNICAL DETAILS**

- Suits 15mm glass

**FS-15SD Heavy Duty Square Deck Mount Spigot****AVAILABLE FINISHES**

- Mirror
- Satin

**TECHNICAL DETAILS**

- Suits 15mm glass



**12mm Frameless Pool Glass Fencing**  
No holes with 2mm radius corners

CODE	WIDE (mm)	HEIGHT (mm)	AREA (sqm)
PG12-100	100	1170	0.12
PG12-150	150	1170	0.18
PG12-200	200	1170	0.23
PG12-250	250	1170	0.29
PG12-300	300	1170	0.35
PG12-350	350	1170	0.41
PG12-400	400	1170	0.47
PG12-450	450	1170	0.53
PG12-500	500	1170	0.59
PG12-550	550	1170	0.64
PG12-600	600	1170	0.70
PG12-650	650	1170	0.76
PG12-700	700	1170	0.82
PG12-750	750	1170	0.88
PG12-800	800	1170	0.94
PG12-850	850	1170	0.99
PG12-900	900	1170	1.05
PG12-950	950	1170	1.11
PG12-1000	1000	1170	1.17
PG12-1050	1050	1170	1.23
PG12-1100	1100	1170	1.29
PG12-1150	1150	1170	1.35
PG12-1200	1200	1170	1.4
PG12-1250	1250	1170	1.46
PG12-1300	1300	1170	1.52
PG12-1350	1350	1170	1.58
PG12-1400	1400	1170	1.64
PG12-1450	1450	1170	1.7
PG12-1500	1500	1170	1.76
PG12-1550	1550	1170	1.81
PG12-1600	1600	1170	1.87
PG12-1650	1650	1170	1.93
PG12-1700	1700	1170	1.99
PG12-1750	1750	1170	2.05
PG12-1800	1800	1170	2.11
PG12-1850	1850	1170	2.16
PG12-1900	1900	1170	2.22
PG12-1950	1950	1170	2.28
PG12-2000	2000	1170	2.34

### 12mm Hinge Panels for Polaris Spring Hinge

CODE	WIDE (mm)	HEIGHT (mm)	AREA (sqm)
PGH12-800	800	1170	0.93
PGH12-1000	1000	1170	1.17
PGH12-1100	1100	1170	1.32
PGH12-1200	1200	1170	1.41
PGH12-1300	1300	1170	1.56
PGH12-1400	1400	1170	1.64
PGH12-1500	1500	1170	1.80
PGH12-1600	1600	1170	1.87
PGH12-1700	1700	1170	2.04
PGH12-1800	1800	1170	2.16
PGH12-1900	1900	1170	2.28
PGH12-2000	2000	1170	2.40

### 12mm Polaris Hinge Gate Panel

CODE	WIDE (mm)	HEIGHT (mm)	AREA (sqm)
PGHG12-800	800	1170	0.93
PGHG12-850	850	1170	1.05
PGHG12-900	900	1170	1.05

### 10mm Spring Hinge Gate Panel

CODE	WIDE (mm)	HEIGHT (mm)	AREA (sqm)
PGSG8-800	800	1170	0.93
PGHG8-850	850	1170	1.05
PGHG8-900	900	1170	1.05

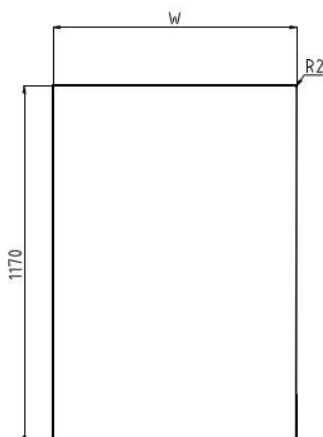

## 12mm Clear Toughened Polaris Pool Gate and Hinge Panel

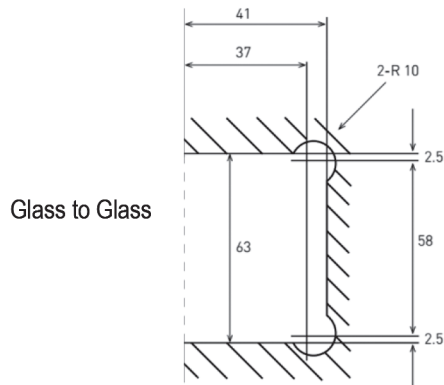
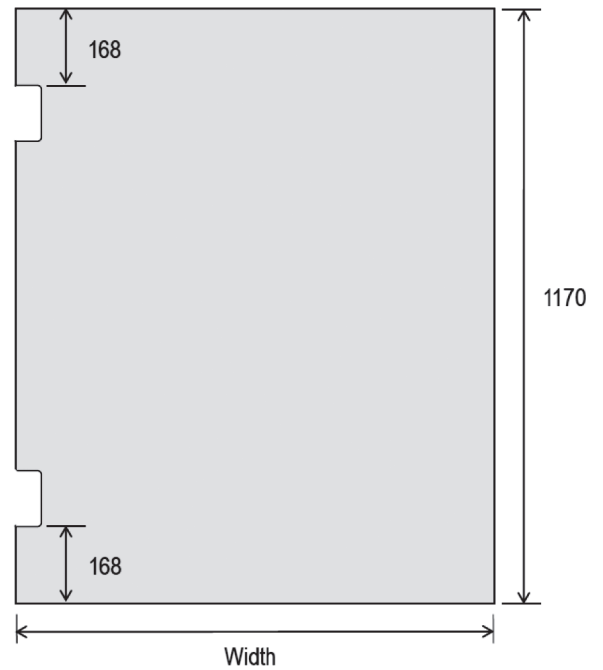
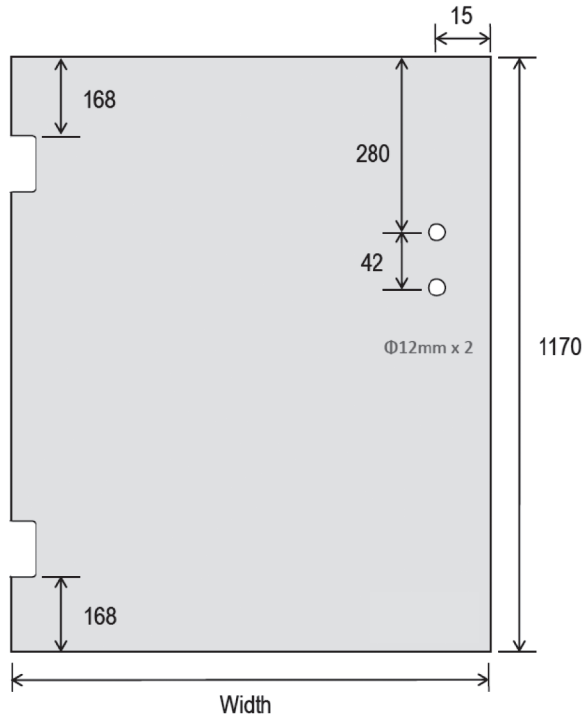

Glass to Glass

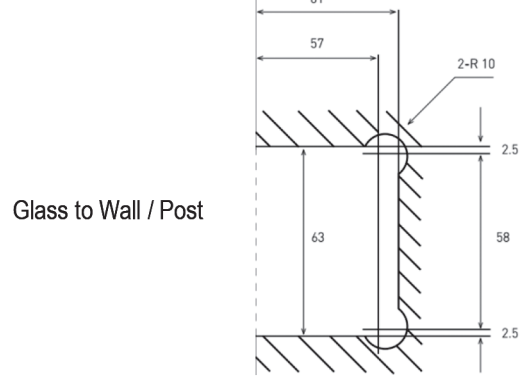

Glass to Wall / Post

7

## GLGGM/GLGGS Glass to Glass Latch

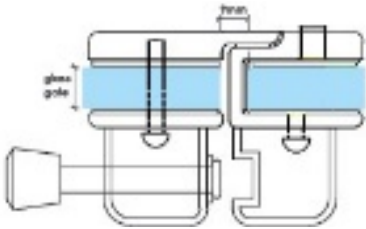

### AVAILABLE FINISHES

- Mirror
- Satin
- Black

### TECHNICAL DETAILS

- Suits 10mm and 12mm glass
- 316 Stainless Steel

## GLGPM/GLGPS Glass to Square Post Latch

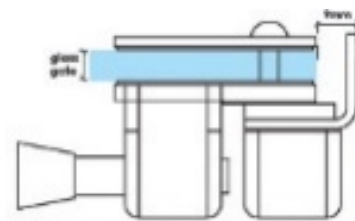

### AVAILABLE FINISHES

- Mirror
- Satin
- Black

### TECHNICAL DETAILS

- Suits 10mm and 12mm glass
- 316 Stainless Steel

## GLRDM/GLRDS Glass to Round Post Latch



### AVAILABLE FINISHES

- Mirror
- Satin

### TECHNICAL DETAILS

- Suits 10mm and 12mm glass
- 316 Stainless Steel

## PGL-L D&D Key Lock



### AVAILABLE FINISHES

- Mirror
- Satin

### TECHNICAL DETAILS

- Retro fit all latches

## Polaris Glass to Wall

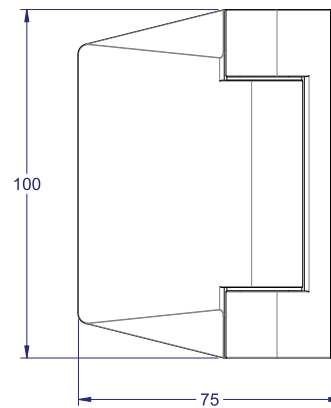
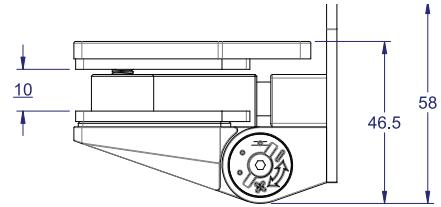
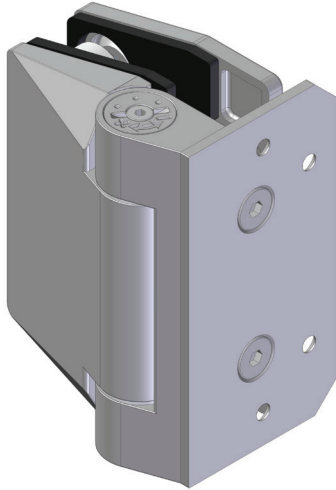

### AVAILABLE FINISHES

- Mirror
- Satin
- Black

### TECHNICAL DETAILS

- Magnets and Hydraulic Dampner
- Suits 10mm and 12mm glass

## Polaris Glass to Glass

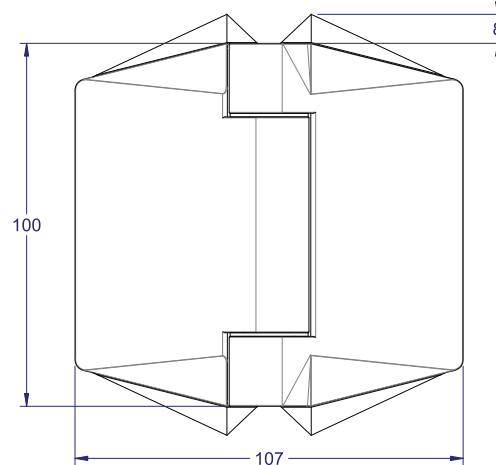
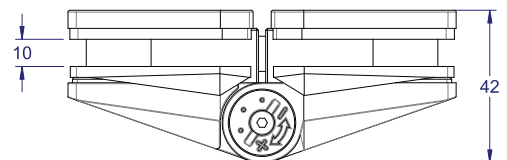

### AVAILABLE FINISHES

- Mirror
- Satin
- Black

### TECHNICAL DETAILS

- Magnets and Hydraulic Dampner
- Suits 10mm and 12mm glass

**GLOM/GLOS** Glass to Glass External Applications**AVAILABLE FINISHES**

- Mirror
- Satin

**TECHNICAL DETAILS**

- Poolgate latch and keeper
- Suitable for 10mm and 12mm glass
- Suits holes in standard door

**GLIM/GLIS** Glass to Glass Internal Applications**AVAILABLE FINISHES**

- Mirror
- Satin

**TECHNICAL DETAILS**

- Poolgate latch and keeper
- Suitable for 10mm and 12mm glass
- Suits holes in standard door

## PGH-180A Glass to Glass Spring Hinge - Heavy Duty



### AVAILABLE FINISHES

- Mirror
- Satin

### TECHNICAL DETAILS

- Suitable for 10mm and 12mm glass

## PGH-SA Glass to Square Post Spring Hinge - Heavy Duty



### AVAILABLE FINISHES

- Mirror
- Satin

### TECHNICAL DETAILS

- Suitable for 10mm and 12mm glass

## PGH-RA Glass to Round Post Spring Hinge - Heavy Duty



### AVAILABLE FINISHES

- Mirror
- Satin

### TECHNICAL DETAILS

- Suitable for 10mm and 12mm glass



## SLH Heavy Duty Spring Hinge



### AVAILABLE FINISHES

- Mirror
- Satin

### TECHNICAL DETAILS

- Suits 10mm and 12mm glass

## SHGGM Spring Hinges



### AVAILABLE FINISHES

- Mirror
- Satin

### TECHNICAL DETAILS

- Suitable for 10mm glass
- 316 Stainless Steel

## SHGRDM/SHGSQM Spring Hinges



### AVAILABLE FINISHES

- Mirror
- Satin

### TECHNICAL DETAILS

- Suitable for 10mm glass
- 316 Grade Stainless Steel

## Spring Hinge Panel and Gate Cut Out Details

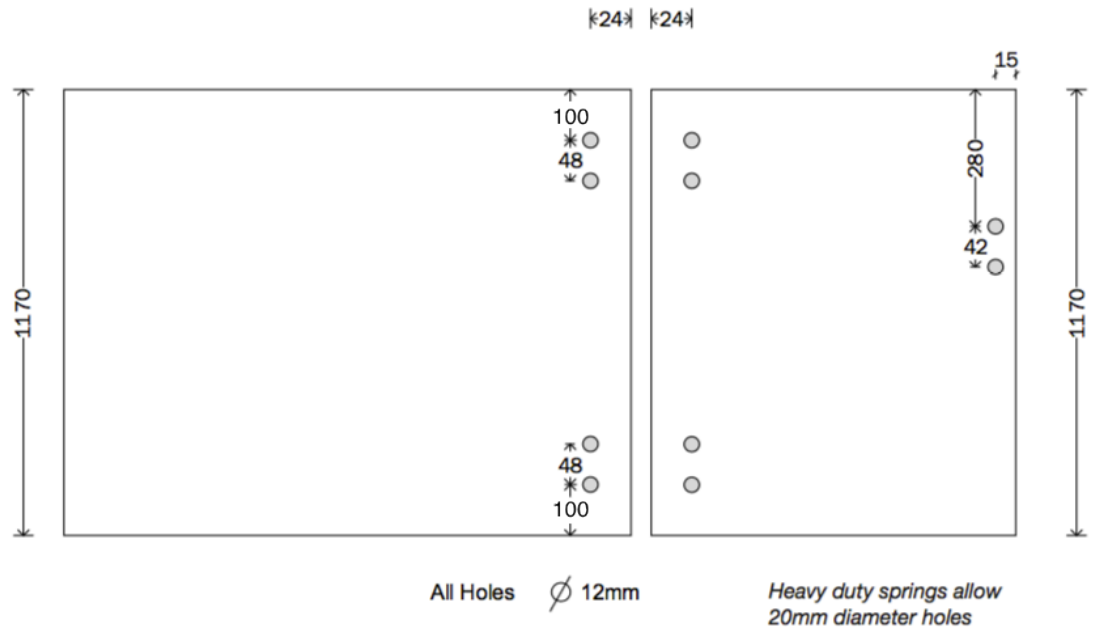

## LP Wall Fixing Glass Clamp



### AVAILABLE FINISHES

- Mirror
- Satin

### TECHNICAL DETAILS

- Suitable for 12mm glass

## LP-90M / LP-90S 90° Glass to Glass Clamp



### AVAILABLE FINISHES

- Mirror
- Satin

### TECHNICAL DETAILS

- Suitable for 12mm glass

## LP-90F 90° Offset Glass to Glass Clamp

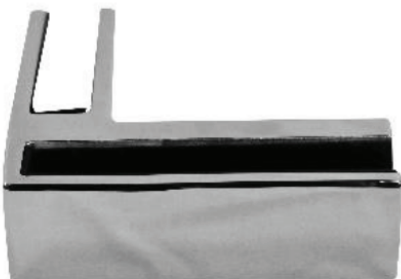

### AVAILABLE FINISHES

- Mirror
- Satin

### TECHNICAL DETAILS

- Suitable for 12mm glass

## LP-135M / LP-135S 135° Glass to Glass Clamp



### AVAILABLE FINISHES

- Mirror
- Satin

### TECHNICAL DETAILS

- Suitable for 12mm glass

## LP-180M / LP-180S 180° Glass to Glass Clamp

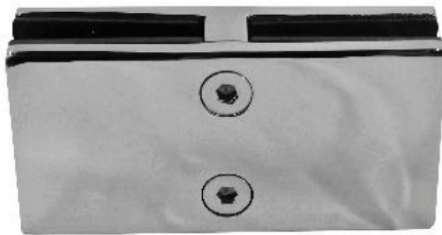

### AVAILABLE FINISHES

- Mirror
- Satin

### TECHNICAL DETAILS

- Suitable for 12mm glass

## LP-ADJ Adjustable Glass to Glass Clamp

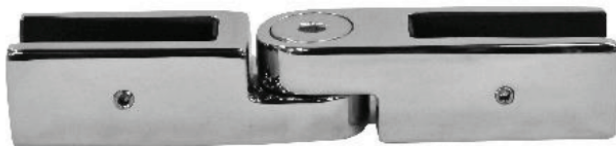

### AVAILABLE FINISHES

- Mirror
- Satin

### TECHNICAL DETAILS

- Suitable for 12mm glass

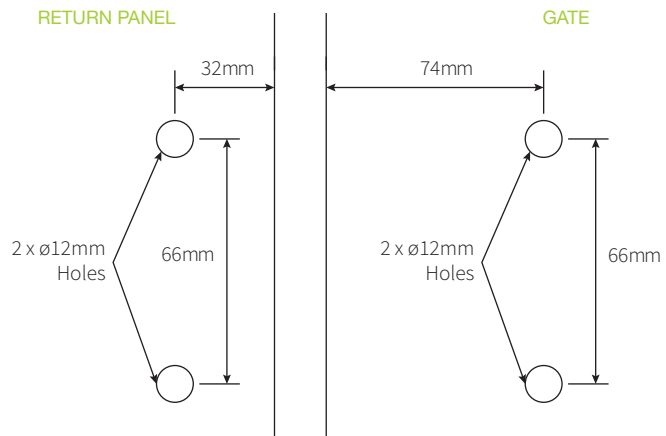
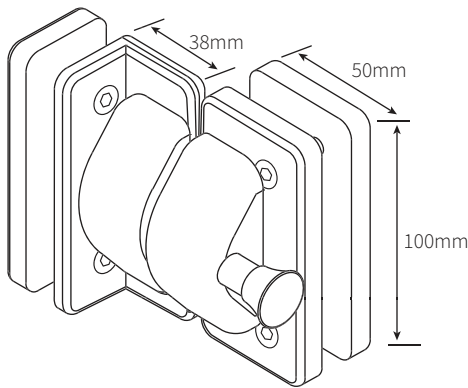
**PL290 Pool Gate Latch and Keeper – Glass to Glass 90°**

**AVAILABLE FINISHES**

- Polished Stainless Steel
- Satin Stainless Steel

**TECHNICAL DETAILS**

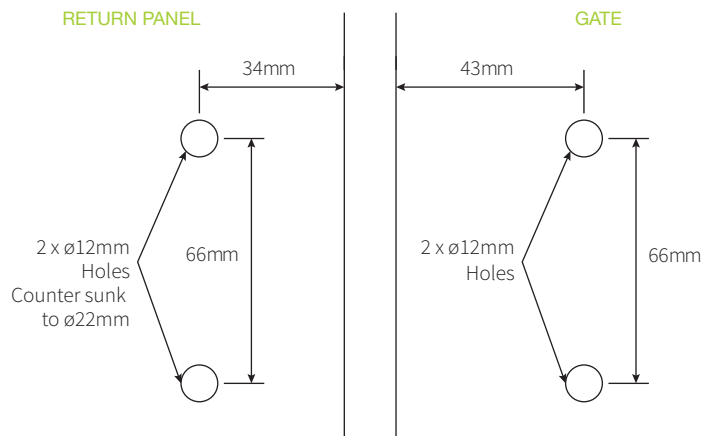
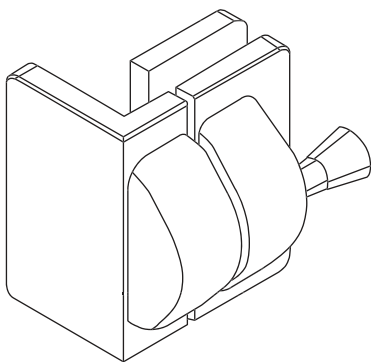
- Designed for a frameless glass pool gate that closes to a post or wall
- Self latching using "Magna" latch
- Minimum door height 1.2 metres
- Suitable for 10mm and 12mm glass thickness, can be adapted for other sizes
- 316 stainless steel

**PL290.R Pool Gate Latch and Keeper – Glass to Glass 90°**

**AVAILABLE FINISHES**

- Polished Stainless Steel
- Satin Stainless Steel

**TECHNICAL DETAILS**

- Designed for a frameless glass pool gate that closes to a post or wall
- Self latching using "Magna" latch
- Minimum door height 1.2 metres
- Suitable for 10mm and 12mm glass thickness, can be adapted for other sizes
- 316 stainless steel

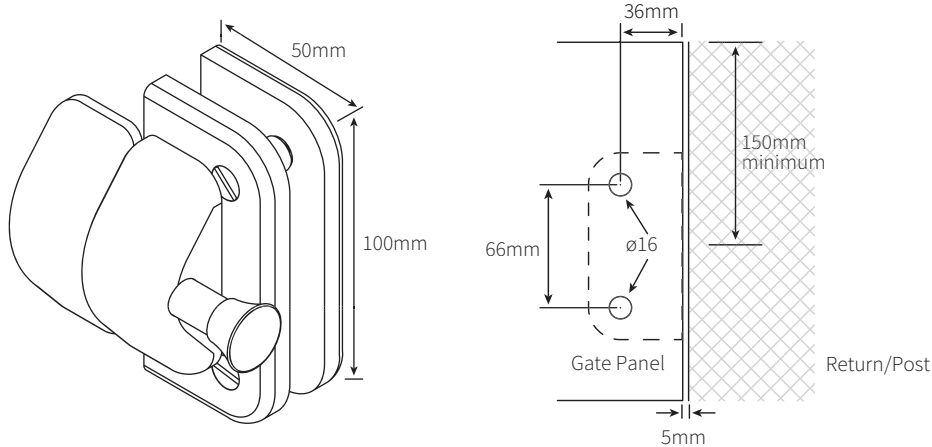
## PL1 Pool Gate Latch and Strike – Glass to Post



### AVAILABLE FINISHES

- Polished Stainless Steel
- Satin Stainless Steel

### TECHNICAL DETAILS

- Designed for a frameless glass pool gate that closes to a post or wall
- Self latching using “Magna” latch
- Minimum door height 1.2 metres
- Suitable for 10mm and 12mm glass thickness, can be adapted for other sizes
- 316 stainless steel

## PL2 Pool Gate Latch and Keeper Glass to Glass

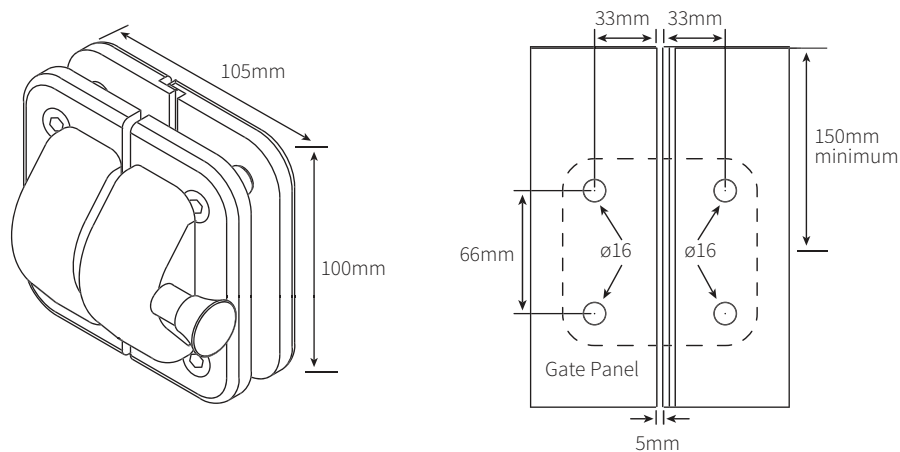

### AVAILABLE FINISHES

- Polished Stainless Steel
- Satin Stainless Steel

### TECHNICAL DETAILS

- Designed for a frameless glass pool gate and side panel
- Self latching using “Magna” latch
- Minimum door height 1.2 metres
- Suitable for 10mm and 12mm glass thickness, can be adapted for other sizes
- 316 stainless steel

## FPF5.P Pivot Top Arm – Glass to Round Post

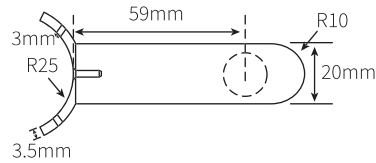
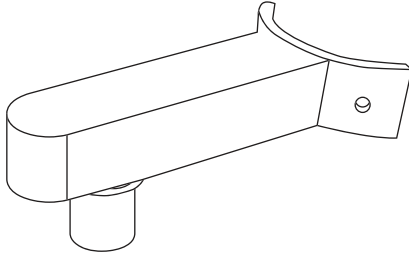

### AVAILABLE FINISHES

- Polished Stainless Steel
- Satin Stainless Steel

### TECHNICAL DETAILS

- Use in conjunction with SBC42400 top patch to allow the gate to pivot from 50mm diameter post
- Suitable for 50mm diameter posts
- 316 grade stainless steel

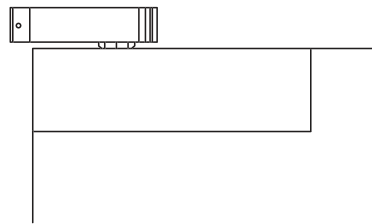

## FPF7 Pivot Top – Bracket

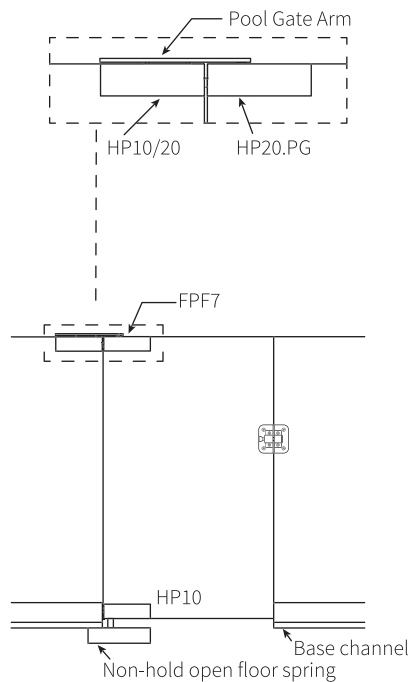
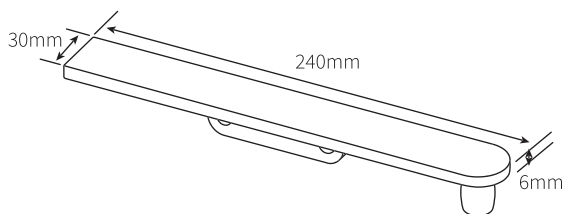

### AVAILABLE FINISHES

- Polished Stainless Steel
- Satin Stainless Steel

### TECHNICAL DETAILS

- Use in conjunction with HP20/HP10 top patch fittings that allow them to work as a top pivot set
- Suitable for mounting a glass gate to a glass balustrade
- 316 grade stainless steel



## FPF790.L (LEFT) / FPF790.R (RIGHT) Pivot Arm – Top 90°

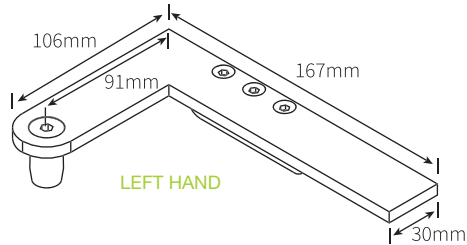

LEFT HAND

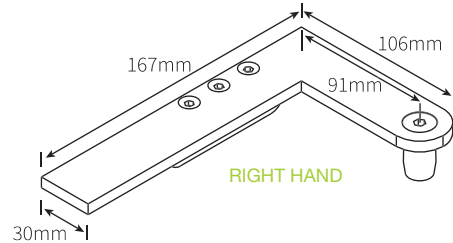

RIGHT HAND

ASSEMBLY (RIGHT HAND SIDE)

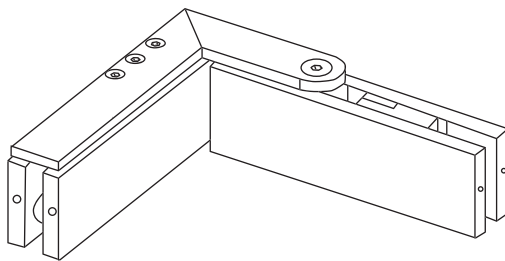

GLASS DETAIL – RETURN PANEL

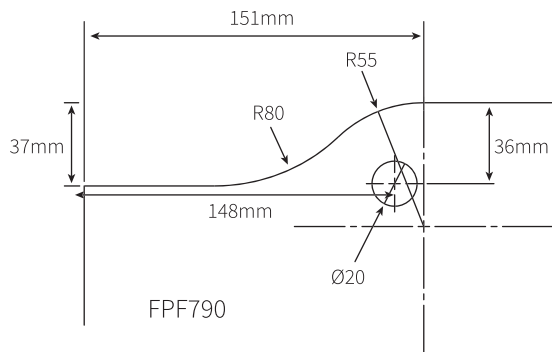

GLASS DETAIL – DOOR

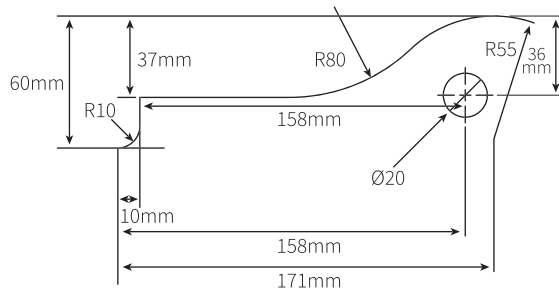

### AVAILABLE FINISHES

- Polished Stainless Steel
- Satin Stainless Steel

### TECHNICAL DETAILS

- Use in conjunction with HP20/HP10 top patch fittings that allow them to work as a top pivot set
- Suitable for mounting a glass gate to a glass balustrade
- 316 grade stainless steel

## FPF7.KIT Pivot Top – Set Kit

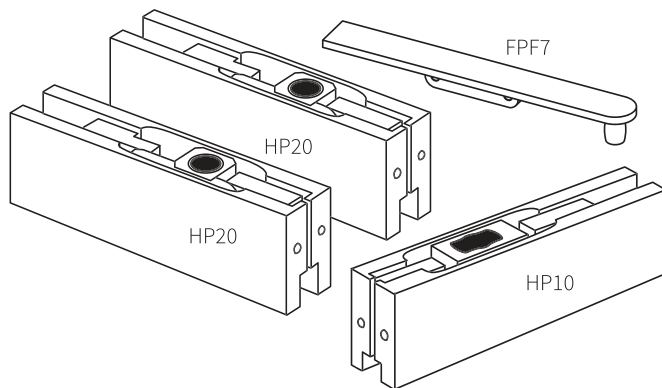

### AVAILABLE FINISHES

- Polished Stainless Steel
- Satin Stainless Steel

### TECHNICAL DETAILS

- Kit includes:
  - Two HP20
  - One HP10
  - One FPFT
- 316 grade stainless steel

## FPF8 Pivot Arm Top – Glass to Solid Wall

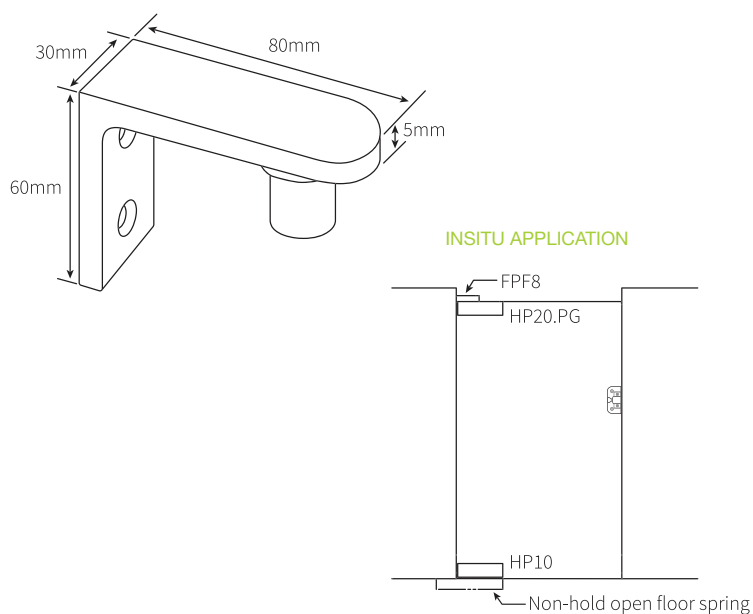

### AVAILABLE FINISHES

- Polished Stainless Steel
- Satin Stainless Steel

### TECHNICAL DETAILS

- Kit includes:
  - Two HP20
  - One HP10
  - One FPFT
- 316 grade stainless steel

## FPF5 Pivot Arm – Glass to Wall

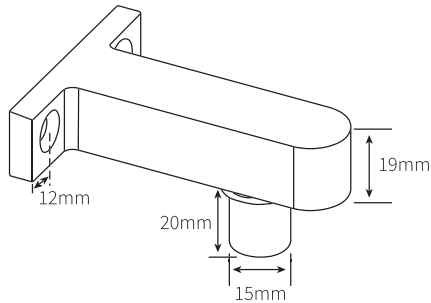

GLASS CUT OUT DETAIL

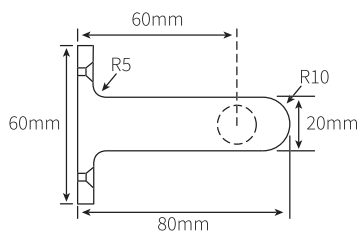

INSITU APPLICATION

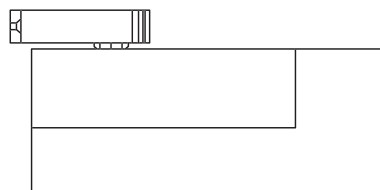

### AVAILABLE FINISHES

- Polished Stainless Steel
- Satin Stainless Steel

### TECHNICAL DETAILS

- Kit includes:
  - Two HP20
  - One HP10
  - One FPFT
- 316 grade stainless steel

## FPF6 Pivot Arm Top – Glass to Glass

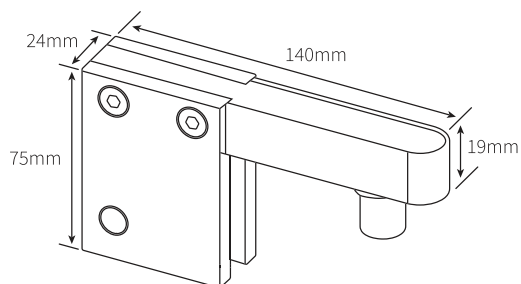

GLASS CUT OUT DETAIL

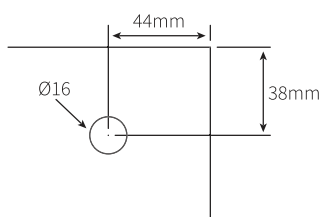

INSITU APPLICATION

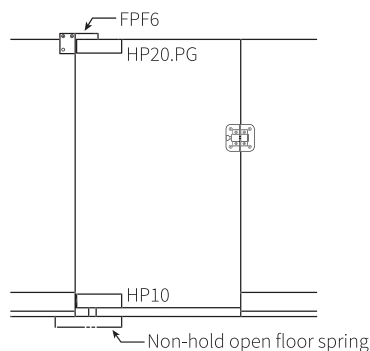

### AVAILABLE FINISHES

- Polished Stainless Steel
- Satin Stainless Steel

### TECHNICAL DETAILS

- Use in conjunction with elite glass standard patch fittings and floor springs
- Suitable for mounting a glass gate to a glass balustrade
- 316 grade stainless steel

## HP20.PG Top Patch Fitting – Suitable for Pool Gate Pivots

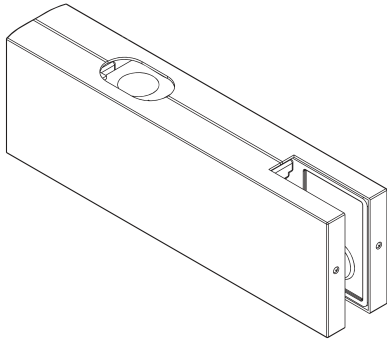

### AVAILABLE FINISHES

- Polished Stainless Steel
- Satin Stainless Steel

### TECHNICAL DETAILS

- Adjustable pivot insert
- Features concealing cover plates
- Suitable for Eliteglass pool gate fittings - FPF5/FPF6/FPF7 and FPF8

## TEA STAINING

### WHAT IS TEA STAINING?

Tea staining can be described as: discoloration of the surface of stainless steel that does not affect the structural integrity or the longevity of the material. Visually it is a discoloration of the metal surface, which tends to follow the 'grain' of any surface finish. Although unpleasant to look at, it is not a serious form of corrosion. Aesthetically it is unacceptable so the following information is designed to help you understand its causes and institute a plan to keep your hardware looking better for longer.

### WHERE AND WHY DOES TEA STAINING OCCUR?

Tea staining of stainless steels occurs most commonly in coastal areas and becomes progressively worse the closer you get to water. Other factors such as pollution, higher temperatures and humidity can also increase the effect. Tea staining occurs when particles gather in surface troughs of the metal and oxidise or corrode. For this reason, rougher surfaces promote tea staining. Smoother surface finishes are cleaner between washes and don't have surface grooves where chlorides (salt) and other contaminants can collect, concentrate and cause problems.

### HOW TO MINIMISE TEA STAINING?

Specify and insist on the right grade - Grade 316 should be selected as a minimum within 5km of the coast, especially outside.

Surface finish - The rule of thumb for surface finish is the smoother the finish, the better the resistance to tea staining.

Perform regular maintenance - Wash regularly with clean fresh water, mild detergent and a cloth or soft brush. After washing rinse in clean water and wipe the surface dry with a soft absorbant cloth remembering to go with the grain on brushed stainless steel. Generally, you should wash your stainless steel every time you wash your windows or every three months. Do not use abrasive cleaners or a scouring pad of any type as they may cause excessive wear and dull the finish. Even smooth stainless steel finishes in coastal environments may show tea staining if not washed regularly.

## TEA STAINING CONT.

With a little bit of care, you can radically minimise, if not prevent tea staining and get years of visual enjoyment from your stainless steel. It must be recognised that keeping a pristine finish requires understanding, additional effort and usually extra cost in the first instance. It is all about determining your expectations of the hardware and planning to achieve and maintain the visual appeal.

### TEA STAINING REMOVAL

Brown discoloration or tea staining of stainless steel in coastal environments is a common problem, but luckily it is one that can be prevented. If you have tea staining there are a few steps to take to bring your stainless-steel back to “as new” condition.

Get a specialist cleaning product such as the 3M Stainless Steel cleaner and a non-scratch cleaning sponge, both readily available from your supermarket.

Apply clean water with the cleaning sponge and rub gently. If the mark won't shift, it may be necessary to use a stainless-steel cleaner, in which case apply the cleaner and rub gently. An old toothbrush can be used to get into any nooks and crannies. After cleaning it is important to rinse the stainless steel with clean fresh water and buff with a soft cloth. Remember to always rub with the grain, NEVER across as you will spoil the finish and the stainless can lose its shine. Also, NEVER use steel wool to clean stainless steel. It is usually made of carbon steel and the fragments left behind as well as scratching the surface will rust onto the stainless-steel surface. If you must use a scourer, use stainless steel wool or a Scotch rite plastic scourer. This will scratch the surface, but will not leave fragments behind to go rusty. On polished stainless steel surfaces this will damage the surface and is not recommended.